



TAP



ATAP

120-02-02-00312	TAP28	'JUJJOHOVUTGPSMODIFT/4UBOEBSE
140-02-02-00011	TAP40	'JUJJOHOVUTGPSMODIFT/
140-02-02-00015	TAP50	'JUJJOHOVUTGPSMODIFT/
140-02-02-00014	TAP60	'JUJJOHOVUTGPSMODIFT/
140-02-02-00010	TAP75	'JUJJOHOVUTGPSMODIFT/
140-02-02-00012	TAP100	Fitting nuts for punches N100
125-02-02-00042	ATAP	Fitting part for TAP100



CAB



CAB N125

Reference	Type	Fitting for dies
120-02-02-00313	N46	Fitting for dies N46 Standard
140-02-02-00019	N60	Fitting for dies N60
140-02-02-00028	N78	Fitting for dies N78
140-02-02-00044	N85	Fitting for dies N85
140-02-02-00029	N100	Fitting for dies N100
140-02-02-00027	N125	Fitting for dies N125

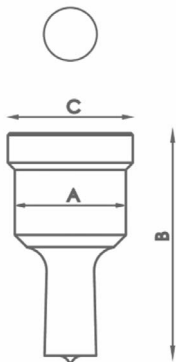

Type	Available sizes in	A	B	C
N28	3/3'5/4/4'5/5/5'5/6/6'5/7/7'5/8 8'5/9mm hasta 28mm de 0'5 en 0'5mm	28 mm	58 mm	31,5 mm
N40	29/30/31/32/33/34/35 36/37/38/39/40mm	40 mm	64 mm	43,5 mm
N50	41/42/43/44/45/46/47/48/49/50mm	50 mm	58 mm	54 mm
N60	52/54/56/58/60mm	60 mm	58 mm	64 mm
N75	62/64/66/68/70/72/74mm	75 mm	58 mm	79 mm
N100	76/78/80/82/84/86/88 90/92/94/96/98/100mm	100 mm	58 mm	104 mm

For different sizes, please ask the manufacturer

Accessories for Hydraulic iron worker MX700

Standard square punches MX700

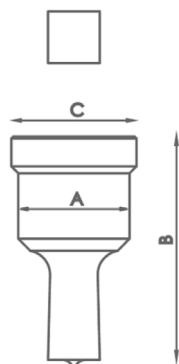

Type	Medidas disponibles en mm Ø	A	B	C
N28	4/5/6/7/8/9/10/11/12/13/14/15 16/17/18/19/20mm	28 mm	58 mm	31,5 mm
N40	21/22/24/26/28mm	40 mm	64 mm	43,5 mm
N50	31/33/35mm	50 mm	58 mm	54 mm
N75	40/44/48/53mm	75 mm	58 mm	79 mm
N100	58/64/70mm	100 mm	58 mm	104 mm

For different sizes, please ask the manufacturer

Standard rectangular punches MX700

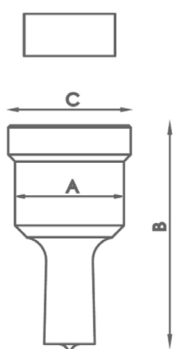

Type	Medidas disponibles en mm Ø	A	B	C
N28	7x10/7x15/9x13/9x19/11x17/11x23 13x19/15x21mm	28 mm	58 mm	31,5 mm
N40	13x25/15x27/17x25/19x30/20x34mm	40 mm	64 mm	43,5 mm
N50	25x43mm	50 mm	58 mm	54 mm
N75	25x70mm	75 mm	58 mm	79 mm
N100	25x96mm	100 mm	58 mm	104 mm

For different sizes, please ask the manufacturer

Standard oval punches MX700

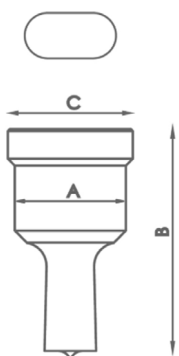

Type	Medidas disponibles en mm Ø	A	B	C
N28	7x10/7x15/7x20/9x13/9x19/11x17 11x23/13x18/13x22/13x27/15x20/15x24 15x27/17x22/17x26/19x26/21x27mm	28 mm	58 mm	31,5 mm
N40	13x31/15x31/17x31/17x40/19x31 19x40/21x31/21x40mm	40 mm	64 mm	43,5 mm
N50	25x45/25x50mm	50 mm	58 mm	54 mm
N75	27x63/27x75mm	75 mm	58 mm	79 mm
N100	30x87/30x100mm	100 mm	58 mm	104 mm

For different sizes, please ask the manufacturer

Accessories for Hydraulic iron worker MX700

Standard round dies MX700

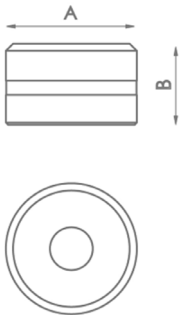

Type	Available sizes in mm	A	B
N46	3/3,5/4/4,5/5/5,5/6/6,5/7/7,5/8/8,5 9mm hasta 28mm de 0,5 en 0,5mm	46 mm	28,5 mm
N60	29/30/31/32/33/34/35/36/37/38/39/40mm	60 mm	32 mm
N78	41/42/43/44/45/46/47/48/49/50mm	78 mm	28,5 mm
N100	52/54/56/58/60/62/64/66/68/70/72/74mm	100 mm	28,5 mm
N125	76/78/80/82/84/86/88/90/92/94/96/98/100mm	125 mm	28,5 mm

For different sizes, please ask the manufacturer

Standard square dies MX700

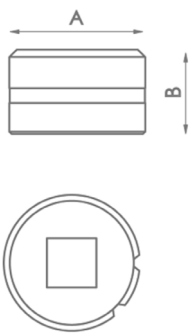

Type	Available sizes in mm	A	B
N46	4/5/6/7/8/9/10/11/12/13/14/15/16/17/18/19/20mm	46 mm	28,5 mm
N60	21/22/24/26/28mm	60 mm	32 mm
N78	31/33/35mm	78 mm	28,5 mm
N100	40/44/48/53mm	100 mm	28,5 mm
N125	58/64/70mm	125 mm	28,5 mm

For different sizes, please ask the manufacturer

Standard rectangular dies MX700

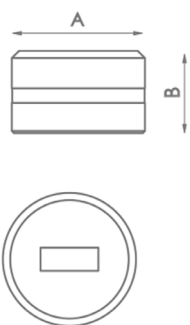

Type	Available sizes in mm	A	B
N46	7x10/7x15/9x13/9x19/11x17/11x23/ 13x19/13x25/15x21mm	46 mm	28,5 mm
N60	15x27/17x25/19x30/20x34mm	60 mm	32 mm
N78	25x43mm	78 mm	28,5 mm
N100	25x70mm	100 mm	28,5 mm
N125	25x96mm	125 mm	28,5 mm

For different sizes, please ask the manufacturer

Accessories for Hydraulic iron worker MX700

Oval dies MX700

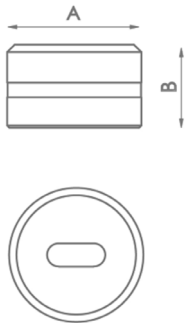

Type	Available sizes in mm	A	B
N46	7x10/7x15/7x20/9x13/9x19/11x17/11x23 13x18/13x22/13x27/15x20/15x24/15x27 17x22/17x26/19x26/21x27mm	46 mm	28,5 mm
N60	13x31/15x31/17x31/17x40/19x31 19x40/21x31/21x40mm	60 mm	32 mm
N78	25x45/25x50mm	78 mm	28,5 mm
N100	27x63/27x75mm	100 mm	28,5 mm
N125	30x87/30x100mm	125 mm	28,5 mm

For different sizes, please ask the manufacturer

Tube notching tooling MX700

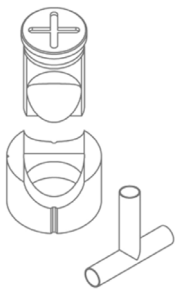

Reference	Available sizes in mm	Required fitting	
MAN28	Tubo de 16 a 28mm	TAP 28	CAB 46
MAN40	Tubo de 28,5 a 40mm	TAP 40	CAB 60
MAN50	Tubo de 40,5 a 50mm	TAP 50	CAB 78
MAN60	Tubo de 50,5 a 60mm	TAP 60	

For different sizes, please ask the manufacturer

Corner rounding tooling MX



Reference	Available sizes in mm	Required fitting	
MRE28	Radio de 3 a 15mm	TAP 28	CAB 46
MRE40	Radio de 16 a 26mm	TAP 40	CAB 60
MRE50	Radio de 26,5 a 32mm	TAP 50	CAB 78

For different sizes, please ask the manufacturer

Accessories for Hydraulic iron worker MX700

Flat bar round end tooling R1 MX700

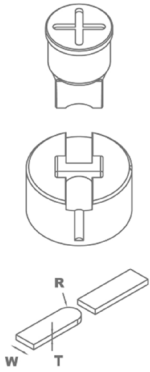

Reference	Model	Width size	Required fitting
MOR1-35A	A	From 20 to 35mm	TAP28 / TAP40
MOR1-35B	B	From 20 to 35mm	TAP28 / TAP40
MOR1-35C	C	From 20 to 35mm	TAP28 / TAP40
MOR1-35D	D	From 20 to 35mm	TAP28 / TAP40
MOR1-50A	A	From 40 to 50mm	TAP50 / TAP60 con ATAP
MOR1-50B	B	From 40 to 50mm	TAP50 / TAP60 con ATAP
MOR1-50C	C	From 40 to 50mm	TAP50 / TAP60 con ATAP
MOR1-50D	D	From 40 to 50mm	TAP50 / TAP60 con ATAP

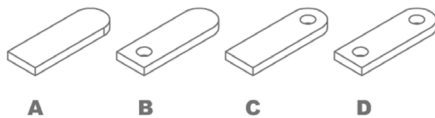

For different sizes, please ask the manufacturer.

When placing order it must be specified the REFERENCE,

MODEL, R (radius), W (flat bar width), T (flat bar thickness)

In models B, C and D specify diameter of the hole.

The ear shaped legth is always adjustable.

Production capacity: 450 to 600 parts per hour.

Flat bar round end tooling R2 MX700

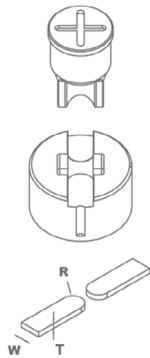

Reference	Model	Width size	Required fitting
MOR2-35A	A	From 20 to 35mm	TAP28 / TAP40
MOR2-35B	B	From 20 to 35mm	TAP28 / TAP40
MOR2-35C	C	From 20 to 35mm	TAP28 / TAP40
MOR2-50A	A	From 40 to 50mm	TAP50 / TAP60 con ATAP
MOR2-50B	B	From 40 to 50mm	TAP50 / TAP60 con ATAP
MOR2-50C	C	From 40 to 50mm	TAP50 / TAP60 con ATAP

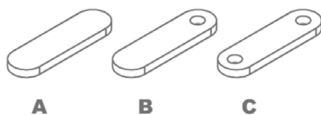

For different sizes, please ask the manufacturer.

When placing order it must be specified the REFERENCE,

MODEL, R (radius), W (flat bar width), T (flat bar thickness)

In models B and C specify hole diameter.

The ear shaped legth is always adjustable.

Production capacity: 450 to 600 parts per hour.