

PRESSES FOR LOCKS

PI85



years

manufacturing industrial machinery



HOW IT WORKS VIDEO

Video on how the machine works

GET A QUOTE

Please complete the following form. We'll contact you in less than 24 hours.

Business days

SOME OF OUR CUSTOMERS

Our customer's endorsement is our best business card



CERTIFICATES AND ACCREDITATIONS

Some of the certificates that support our processes and benefit our customers

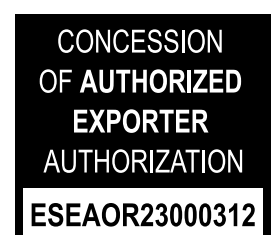

TECHNICAL FEATURES

The Hydraulic Press PI85 NARGESA, is a novelty in the world of locks. It was patented by Nargesa in 2006 which makes us leaders in the manufacturing of this kinds of machines. They fit 85% of locks of all trademarks and models.



- > Normally, one operative has an average time between 30 - 45 minutes to make one whole operation for a casing, handle holes and the lock hole in a square or rectangular pipe. With the PI85 Nargesa the time gets reduced to less than one minute. This is a machine for high production.
- > The finish is perfect, with the proper tolerance to place the lock with no need to use a bezel. Thus the assembling time is minimum.
- > Many companies that have bought this press for locks PI85, not only for their own use but also to sell the ready-to-be-used pipes to other companies.
- > The pipes that can be used with the machine are 35x35, 40x40, 40x50, 40x60, 40x70, 40x80, 50x50, 50x60, 50x70 and 50x80.
- > Pipe thickness can be 1,5 mm and 2 mm. No matter the material, it can either punch normal steel, galvanized steel or stainless steel.
- > It's important to bear in mind the casing must be always made in the side of 35, 40 or 50 mm.
- > The perforation of the lock hole and the handle could be combined, it means we can punch a pipe with lock and handle on both ends, as we can as well make either the handle or the lock in the other.
- > The casing length is adjustable as it is as well the entrance of the lock. It ranges from 18 mm to 37 mm.

** All our products are manufactured in our facilities in Spain. The hydraulic and electrical components are all standard from the best leading European trademarks, with technical assistance all over the world: Rexroth, Bosch, Roquet, Schneider Electric, LG, Telemecanique, Pizzato etc...*

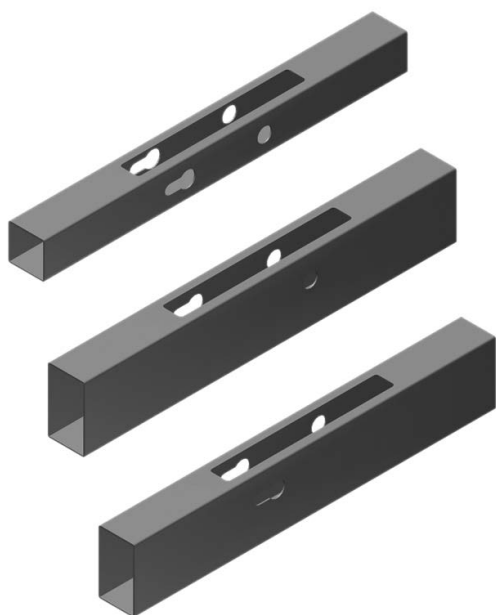

The Hydraulic Press for Locks Nargesa allows making different kinds of punching operations:

- > Punching for mechanism entrance, the lock and handle to both sides.
- > Punching for mechanism entrance, the lock and handle in only one side.
- > Punching for mechanism entrance, the lock with no handle.

> The types of punching are applicable to all the pipes the machine can work with:
 35x35 / 40x40 / 40x50 / 40x60 / 40x70 / 40x80
 / 50x50 / 50x60 / 50x70 / 50x80

DIE DIMENSIONS

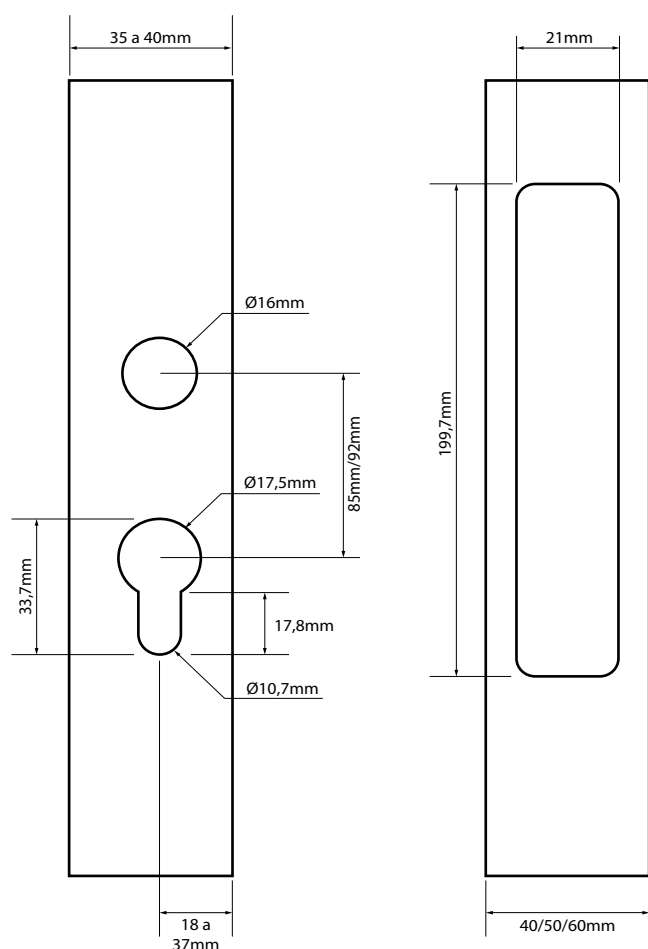

EXAMPLES, BRANDS AND LOCKS

TESA

Ref 2010B, 2211, 2240, 2241, 2230, 2231, 2236, 2237

SERRALLER

Ref 20020, 20023, 20025, 20028, 20030, 20035

LINCE

Ref 5530, 5532, 5542, 5570, 5571, 5572, 5590, 5402, 5403

MCM

Ref 1650, 1449, 1450, 2449, 2450, 2419, 2350

For different sizes please ask the manufacturers.

DETAILED CHARACTERISTICS



Operation time

58 seconds (aprox.)



Type of keyhole

Cylinder lock



Type of material

Iron, stainless steel, galvanized.



Pipe Thickness

1,5 mm and 2 mm.



Casing length.

Adjustable



Lock entrance

Adjustable from 18 mm to 37 mm



Distance between axis

85 mm



Motor power

0,75 kW / 1 CV



3-phased tension

230 / 400V



Dimensions of the machine

1500x570x1470 mm



Weight

200 Kg

OUTSIDE DIMENSIONS

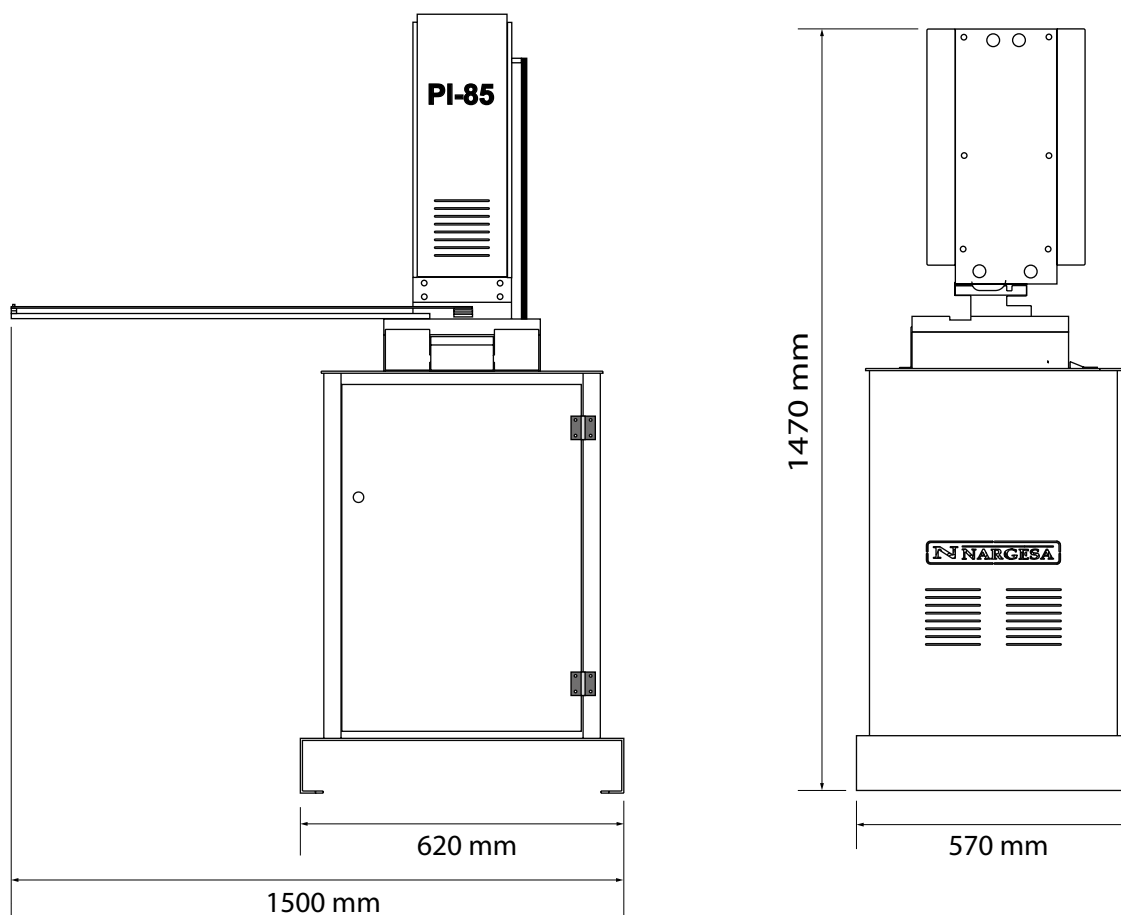

PACKAGING CHARACTERISTICS

- Tariff Item Code: 84624900
- Lower bench palletized to easily transport the machine to the workplace or store it in case of lacking space.
- The machine is shipped fully assembled.
- Pallet made of steel and 3 layer cardboard box suitable for seafreight.
- Optional: Fumigated wooden box NIMF15.

PI85

Width	660 mm
Depth	580 mm
Height	1640 mm
Volume	0,63 m ³
Net Weight	200 Kg
Gross Weight	212 Kg

OPTIONAL ACCESSORIES

Tooling for 35x35 pipe. Wall thickness 1,5mm

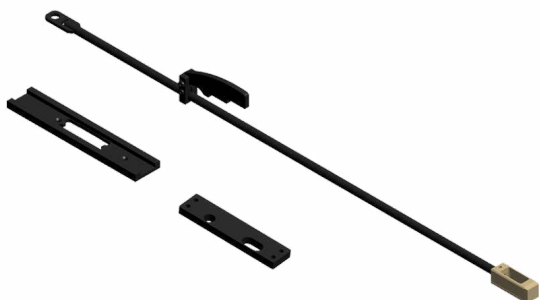

REF: 140-07-01-00001

Pipe: 35x35mm.

Thickness: 1,5mm.

Pieces per die: 3 Units.

Weight: 5 kg.

Optional Tooling.

Tooling for 40x40mm pipe up to 40x80mm. Wall thickness 1,5mm

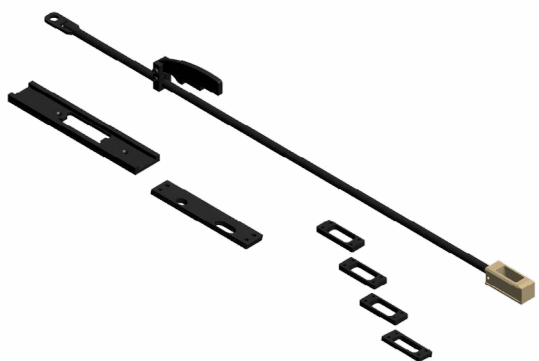

REF: 140-07-01-00003

Pipe: 40x40mm, 40x50mm, 40x60mm, 40x70mm, 40x80mm.

Thickness: 1,5mm

Pieces per die: 8 Units.

Weight: 5,3 kg.

Optional Tooling.

Tooling for 40x40mm pipe up to 40x80mm. Wall thickness: 2mm

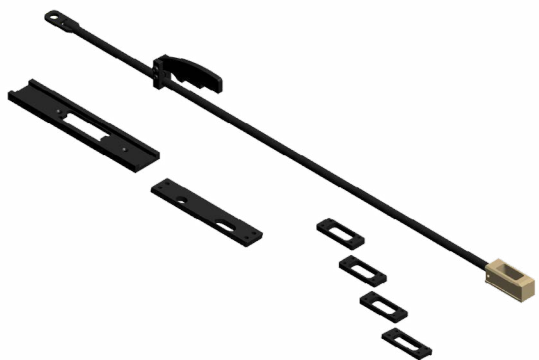

REF: 140-07-01-00004

Pipe: 40x40mm, 40x50mm, 40x60mm, 40x70mm, 40x80mm.

Thickness: 2mm

Pieces per die: 8 Units.

Weight: 5,3 kg.

Optional Tooling.

Tooling for 50x50mm pipe up to 50x80mm. Wall thickness 1,5mm.

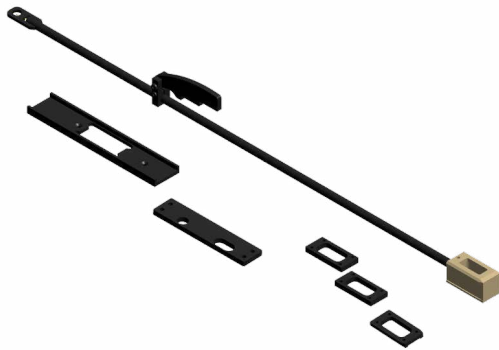

REF: 140-07-01-00005

Pipe: 50x50mm, 50x60mm, 50x70mm, 50x80mm.

Thickness: 1,5mm.

Piece per die: 7 Units.

Weight: 5,5 kg.

Optional Tooling.

Tooling for 50x50mm pipe up to 50x80mm. Wall thickness 2mm.

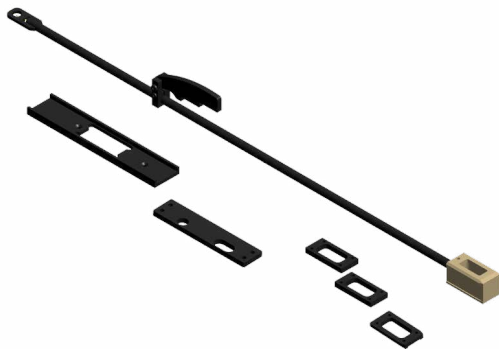

REF: 140-07-01-00006

Pipe: 50x50mm, 50x60mm, 50x70mm, 50x80mm.

Thickness: 2mm.

Pieces per die: 7 Units.

Weight: 5,5 kg.

Optional Tooling.

OUR RANGE OF MACHINERY



IRON WORKERS



SECTION BENDING
MACHINES



NON-MANDREL PIPE
BENDER



HORIZONTAL PRESS
BRAKES



TWISTING/SCROLL
BENDING MACHINES



HYDRAULIC PRESS
BRAKES



HYDRAULIC SHEAR
MACHINES



GAS FORGES



IRON EMBOSSING
MACHINES



END WROUGHT IRON
MACHINES



BROACHING MACHINES



POWER HAMMERS



PRESSES FOR LOCKS

WARRANTY

Nargesa machines have 3 years warranty provided that the customer registers it in our website. Otherwise it would be only one year warranty. This one encloses any manufacturing default all along these 3 years for components. Any misuse is excluded from this condition. Labor, back and forth shipping and any eventual repair, are not included in this warranty.

Partner companies



SHIPMENT EVERYWHERE

Nargesa will arrange transport up to final destination, whenever the customers asks for so. There is also the possibility for the customer to arrange the shipment himself with his own agency.

TECHNICAL ASSISTANCE

All our customers have access to technical support quickly and efficiently. 90% of incidences are solved out on the phone, mail, Skype or videoconferencing in less than 24hours. In case of needing presencial technical assistance, we may as well send a technician to the customer's facilities.

Follow us on

PRADA NARGESA, S.L.

Ctra. De Garrigàs a Sant Miquel s/n

17476 Palau de Santa Eulalia (Girona) Spain

Tel. +34 972 568 085

www.nargesa.com

nargesa@nargesa.com



This information might undergo changes